

# SPIDERTECH

## Specification Sheet

### ST- Led Channel 7

This Spidertech aluminum LED Channel #7 with a circular lens is designed to enhance lighting output and expand illumination across a 180-degree range. Key features include:

- Material: Durable, high-quality aluminum for optimal heat dissipation and long-term performance.
- Circular lens: Equipped with a circular lens that maximizes light output, expanding illumination over a wide 180-degree angle.
- Enhanced brightness: The lens design increases light diffusion, delivering more illumination for larger or more open areas.
- Integrated Hook & Loop system: Features a Hook & Loop system for quick, tool-free installation.
- Easy maintenance: The LED Channel can be easily removed and reinstalled, ideal for installations in hard-to-reach places.
- Compatibility: Works with all standard LED strips.
- Wide light coverage: The 180-degree beam spread ensures even light distribution across large surfaces, reducing shadows and hotspots.
- Sleek appearance: Provides a modern, clean look while improving the overall lighting quality with its expansive light spread.

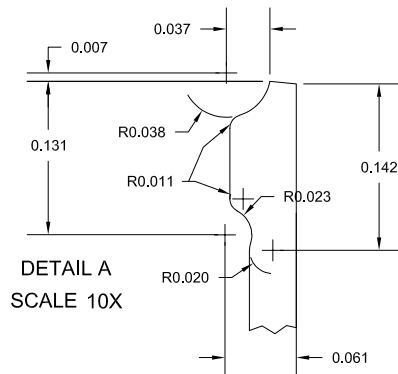
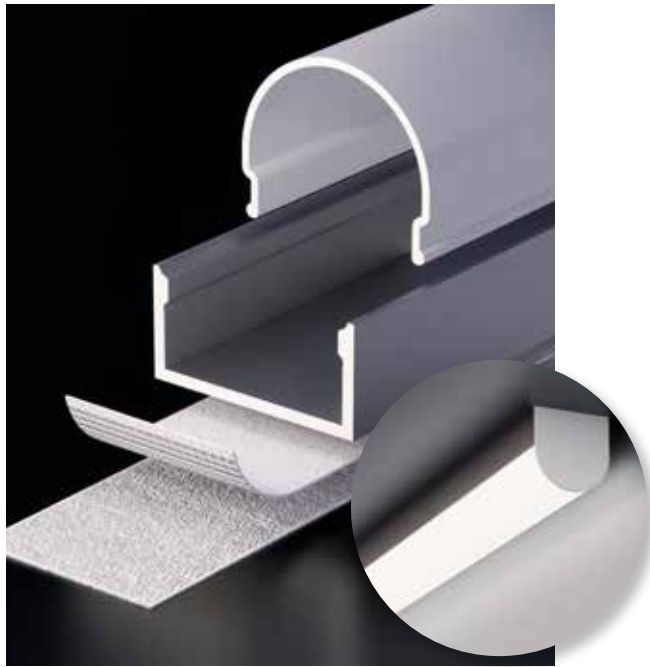

This LED Channel is perfect for spaces requiring extensive light coverage with a professional and polish it finish

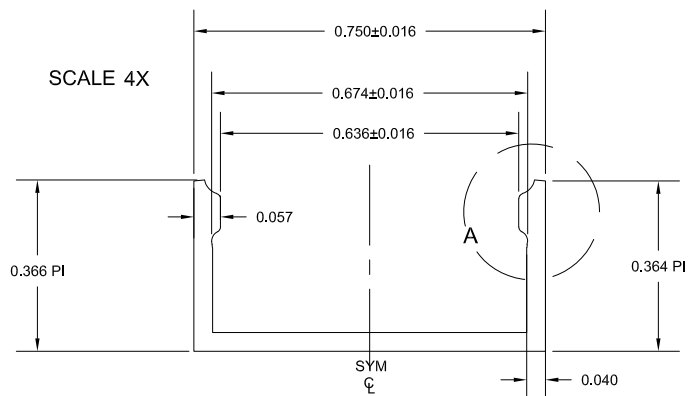
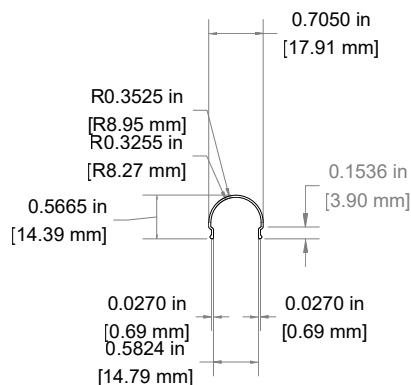

STRAIGHTNESS: .0125 PER FOOT

TWIST: 1° PER FOOT, 7° TOTAL

FLATNESS: .004 PER INCH

UNMARKED WALLS: .040

UNMARKED CORNERS: .010

CLASS: SOLID

MATERIAL: ALUM. 6063-T5

UNLESS OTHERWISE NOTED ALL DIMENSIONS WILL CONFORM TO THE ALUMINUM ASSOCIATION PUBLISHED STANDARDS

AREA .058 SQ.IN

WT/FT. .070 LBS.

PERIM: 2.891 IN.

FACTOR 42

C.C.D. .9 IN.

X.XXX  
DENOTES  
CRITICAL  
DIMENSION

X  
DENOTES QUALITY  
DIMENSION CHECK

# SPIDERTECH